

Priestfields, Leigh, WN7 2RX  
£750 PCM



BALMER & CO are delighted to offer TO RENT this two bedroom purpose built first floor apartment. Accommodation comprises in brief, communal entrance with secure intercom entry system, private entrance hall, living room with Juliet balcony, fitted kitchen with dining area, two well proportioned bedrooms, master with built in wardrobes and en-suite shower room, and further bathroom. Outside are communal gardens with allocated and visitor parking.

## Floor Plan

FIRST FLOOR  
593 sq.ft. (55.1 sq.m.) approx.

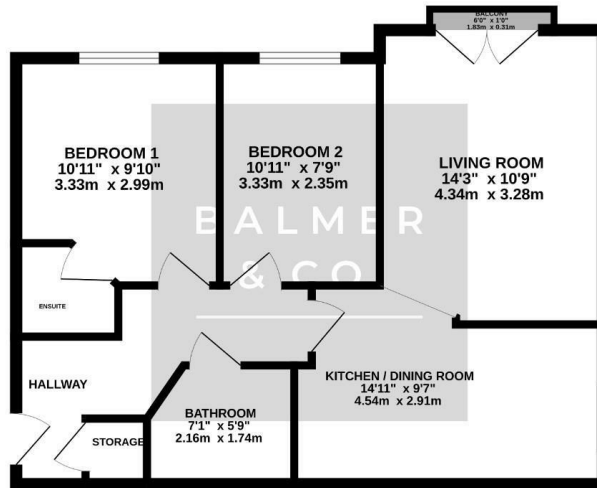

TOTAL FLOOR AREA: 593 sq ft. (55.1 sq.m.) Approx.  
While every attempt has been made to ensure the accuracy of the floorplan contained herein, measurements of doors, windows, stairs and any other details are approximate and not responsible to claim for any error or omission in the plan. This plan is for guidance purposes only and should be used as such by any prospective purchaser. The fixtures, fittings and appliances shown here are not intended to be used as such by any person who is not a tenant of the property.  
Map data ©2026 Google

## Area Map

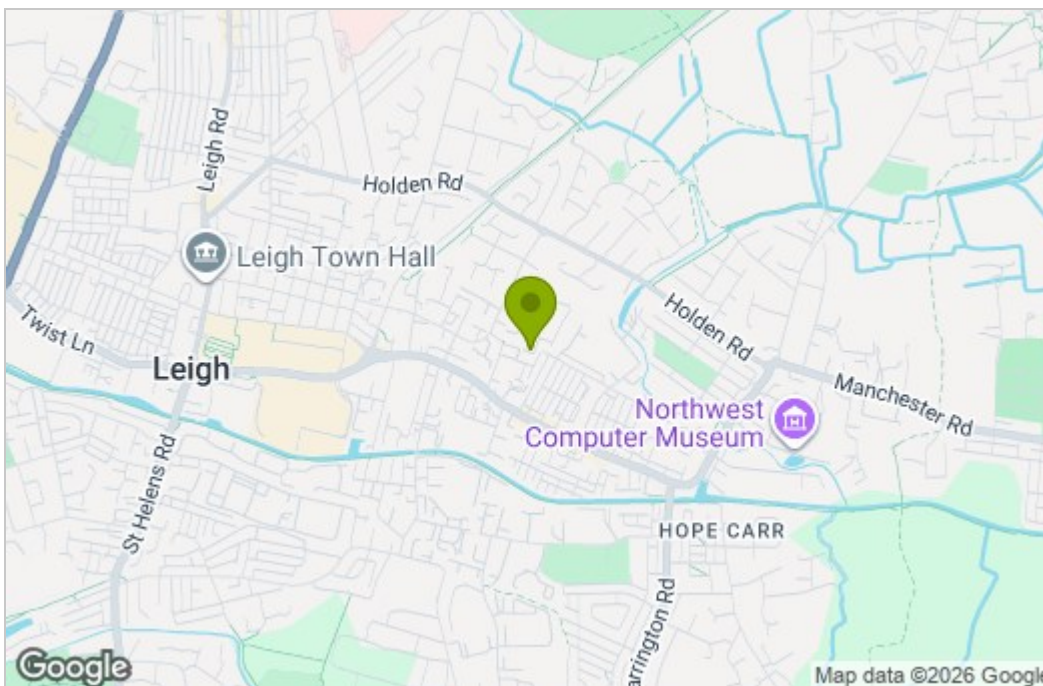

## Energy Efficiency Graph

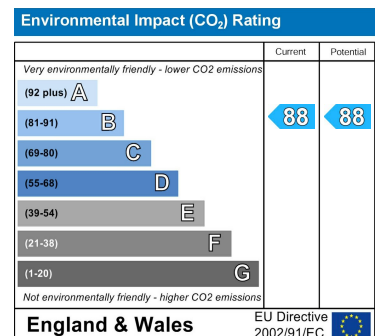
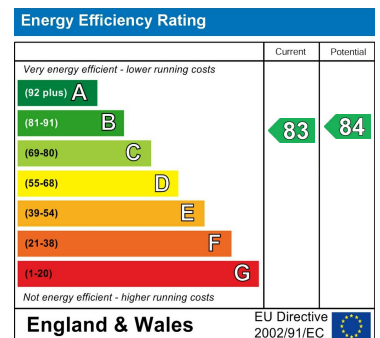

These particulars, whilst believed to be accurate are set out as a general outline only for guidance and do not constitute any part of an offer or contract. Intending purchasers should not rely on them as statements of representation of fact, but must satisfy themselves by inspection or otherwise as to their accuracy. No person in this firm's employment has the authority to make or give any representation or warranty in respect of the property.